

Plugs, Jacks, Adapters

F type plugs are available in three different crimp styles: two piece with separate ferrules, one piece crimp with a short crimp body and a one piece crimp with a long body. Also, a twist-on type for tool-less installations. Jacks for bulkhead, inline, or PC board, and a variety of adapters are all machined brass construction.

Part Number	Description	RG/U Cable	Fig. No.
810A209A	2 Piece Crimp Plug, Short Ferrule	6	117
810A209D	2 Piece Crimp Plug, Short Ferrule	11	117
810A209G	2 Piece Crimp Plug, Short Ferrule	59	117
810B209G	2 Piece Crimp Plug, Long Ferrule	59	118
810D209A	2 Piece Crimp Plug, Short Ferrule	6	119
810A209MV	4 Pc Crimp Mini Coax. Uses BD11007 Tool	174	117A
810D209D	1 Piece Crimp Plug, Short Ferrule	11	119
810D209G	1 Piece Crimp Plug, Short Ferrule	59	119
810E209A	1 Piece Crimp Plug, Long Ferrule	6	120
810E209D	1 Piece Crimp Plug, Long Ferrule	11	120
810E209G	1 Piece Crimp Plug, Long Ferrule	59	120
810A409A	Twist-On	6	121
810A409G	Twist-On	59	121
810P209A	Push-On	6	122
810P209G	Push-On	59	122
816B519	Male Bulkhead Receptacle. 3/8-32 THD I.D.	Any	130A
826B519	Bulkhead Jack, Solder Tab	Any	123
832A519N	Inline Female/Female W/Nut & Washer	N/A	124
830A509	Inline, Male/Male	N/A	125
831B509	Inline Female/Male Push-On	N/A	125A
832A519	Inline Female/Female	N/A	126
843A509	"T" Adapter, Female/Male/Female	N/A	127
845A509	"T" Adapter, Female/Female/Female	N/A	128
851A509	Right Angle Adapter, Male/Female	N/A	129
F0884	75 Ohm Male Terminator	N/A	130

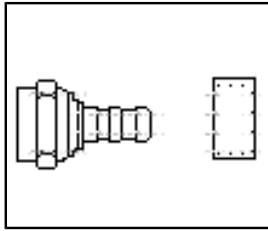

Fig. 117

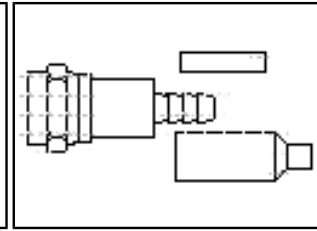

Fig. 117A

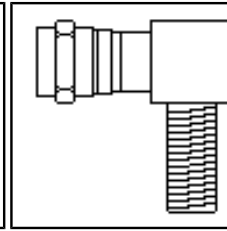

Fig. 118

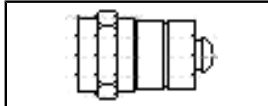

Fig. 119

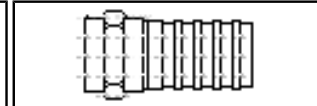

Fig. 120

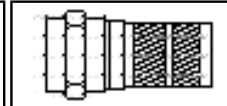

Fig. 121

Also See Push-EZ™ Next Page

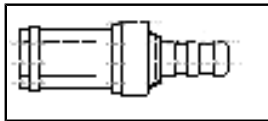

Fig. 122

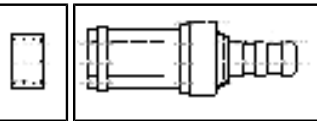

Fig. 123

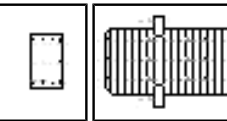

Fig. 124

s

Adapters & Terminators

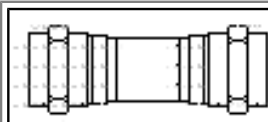

Fig. 125

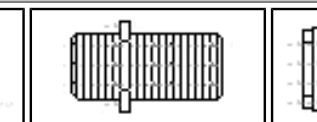

Fig. 126

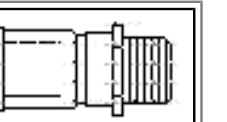

Fig. 125A

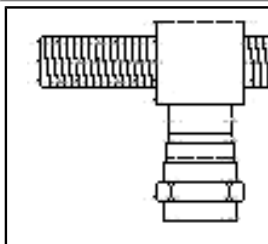

Fig. 127

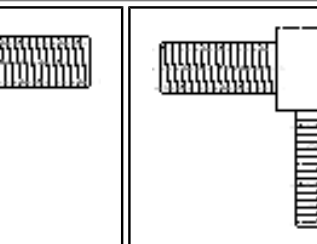
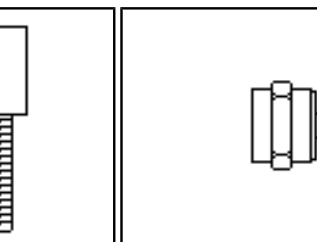
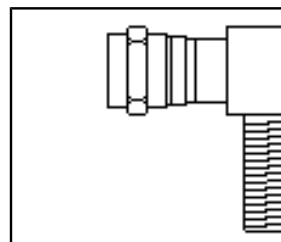

Fig. 128

s

This recessed male acts as a jack & allows for a replaceable female end by using a 832A519 adapter. Also, this can be used to accommodate any adapter with a female F interface on one side. The other end can be BNC, TNC, or any style available. (See adapter pages)



SS

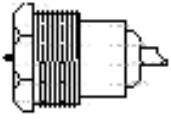
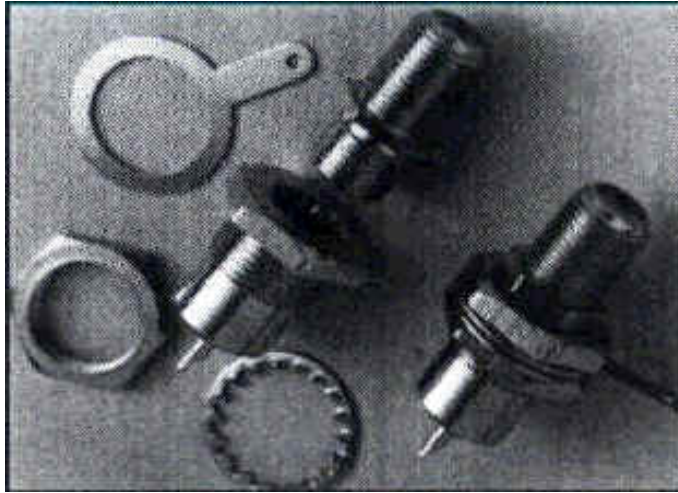

Fig. 130A2

3/8 - 32 Internal Thd. 1/2 - External Thd.



S

S

